



CL1000 Series

Locks & latches



Schlage CL1000 Series cabinet door and drawer locks use full size high quality Schlage cylinders. Cabinet locks can be master keyed to other Schlage locks, providing the convenience of a single-key operation. The CL1000 series is quick and easy to rekey.

Features

- Suitable for either cabinet door or drawer applications
- Suitable for doors from 22mm to 35mm thick
- 25mm throw steel deadbolt for added strength
- Schlage solid brass 6 pin cylinder
- Cylinder housing rotates to allow vertical or horizontal bolt throw
- Cylinder retaining screw for quick and easy rekeying
- The 10 year warranty provides specifiers and users with assured quality and performance

Specification guide

Model	Finish
Cabinet lockCL1000	Satin chrome plate.....SCP

1. Model
Select the desired model e.g. Cabinet lockCL1000
2. Finish
Select the desired finish e.g. Satin chrome plate CL1000SCP

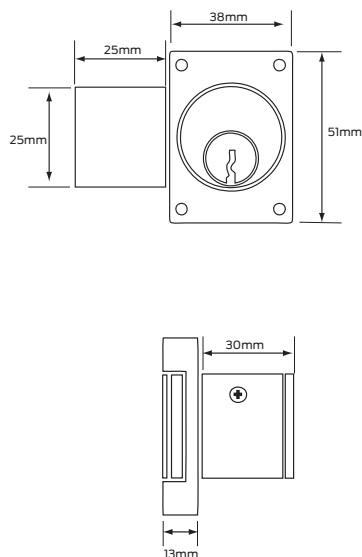

Specifications

Door type	Timber or metal
Door thickness	22mm to 35mm
Lock case	Zinc 29mm diameter housing
Bolt	Steel 25mm throw
Strike plate	Delrin
Bar strike	Delrin
Backsets	19mm minimum 32mm maximum
Key cylinder	Schlage C6 pin keyway standard, Schlage Everest D keyway
Finish	Satin chrome plate
Warranty	10 year mechanical

Schlage CL1000 Series accessories

Packer

Supplied in pairs with locks

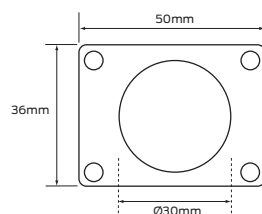

Bar strikes

Supplied with locks

